

**ABOUT JOSH BYRNE & ASSOCIATES**

JBA offers an integrated mix of landscape design, sustainability consultancy, environmental communication and community engagement services for development projects of different scales. JBA focuses on projects that are genuinely committed to being innovative and sustainable.

**WHAT WE DO**

JBA's approach to industry best practice sustainable landscape development aims to deliver high-quality, attractive, and water sensitive landscaping that incorporates local or regional plant species, efficient irrigation systems, appropriate soil conditioning and mulching, low impact materials with reduced embodied energy; provides a good thermal performance interface with the built form; and promotes and enhances key natural assets and landforms.

Depending on the type of project and client requirements, our services can also include design and integration of water management systems (rainwater harvesting, wastewater treatment and reuse, stormwater flows and infiltration), organic waste recycling systems, revegetation and stewardship programs, local food production, public art and other community activation opportunities.

In addition to detailed landscape design and documentation, JBA's sustainability consultancy, environmental communication and community engagement services can add value, create linkages and help promote the achievements of a project.

**OUR TEAM**

JBA's team has backgrounds in the fields of landscape design, environmental science, sustainability policy, architecture, engineering, project management, community development, media and communications.

All have extensive experience working within a broad range of disciplines in their respective industries.

**Onslow Community Garden**

Design of a sustainable community oriented landscape for the Shire of Ashburton focused on the integration of productive gardens with the aim of developing community skills in food production and organic gardening, while providing a focal point for community gatherings and cultural celebration. The project included onsite consultation with community groups and stakeholders, site analysis, detailed design and documentation.

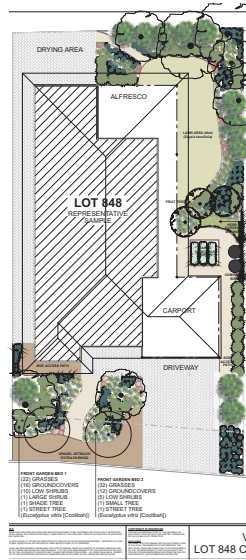

**FMG VTEC Landscape Design Detailed Sample Plans**

Development of landscape design detailed sample plans for FMG's housing construction in South Hedland. The various plans were developed to suit the standard lot/house types of different builders and assist the landscape construction works undertaken by FMG's Indigenous Vocational Training and Employment Centre (VTEC) program. JBA's services included the costing of landscaping materials, equipment and labour to properly inform VTEC's work, and formed part of a broader sustainability consultancy and design role for FMG's housing construction in South Hedland.



**Water Corporation Landscape Concept Plans**

Development of landscape concept plans and plant lists for a variety of different garden types and regions throughout WA, which will be showcased on the Water Corporation's website.

For more information, please visit our website and download a copy of **JBA's Capacity Statement:** [www.joshbyrne.com.au](http://www.joshbyrne.com.au)

